

Date:	
Type:	
Firm Name:	
Project:	

# LinearPro Wall Washer VAC

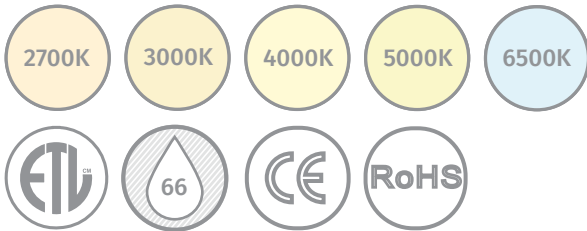

## Specifications

Product Code	Color	Nominal Length	Wattage	Input	Technology	Beam Angle	Operating Temperature	Aluminum Finish
W-LP12-9-AWXO-XX	White	12"	9W	120-220VAC	ON/OFF	20°, 35°, 10° x 40°	14°F - 122°F	RAL9006 (Grey)
W-LP24-18-AWXO-XX	White	24"	18W	120-220VAC	ON/OFF	20°, 35°, 10° x 40°	14°F - 122°F	RAL9006 (Grey)
W-LP36-27-AWXO-XX	White	36"	27W	120-220VAC	ON/OFF	20°, 35°, 10° x 40°	14°F - 122°F	RAL9006 (Grey)
W-LP48-36-AWXO-XX	White	48"	36W	120-220VAC	ON/OFF	20°, 35°, 10° x 40°	14°F - 122°F	RAL9006 (Grey)

\* White options of 2700K, 3000K, 4000K, 5000K, 6500K

## Cable Conductor Specifications

Cable	Function	Wire Color
Power Lead In	AC Live	Black
	AC Neutral	White
	AC Ground	Green



# Product Specification

Units: mm

W-LP12-9-AWXO-XX

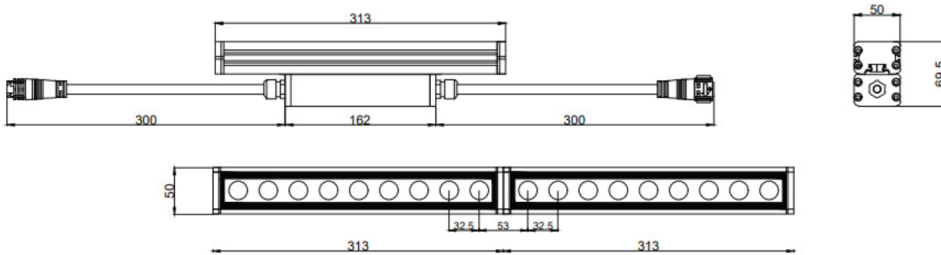

W-LP24-18-AWXO-XX

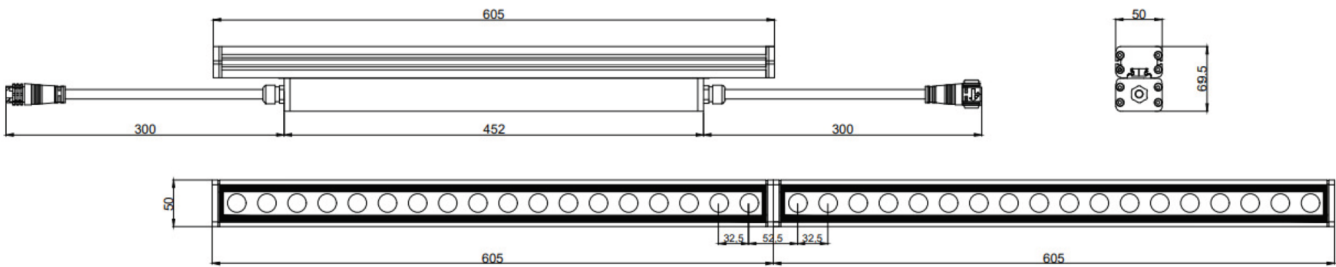

W-LP36-27-AWXO-XX

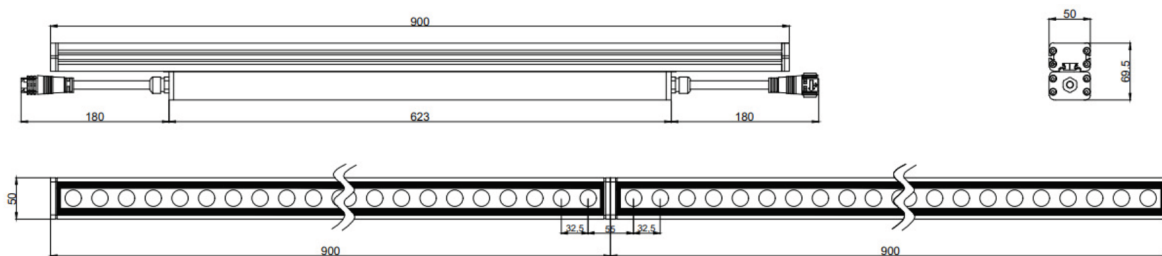

W-LP48-36-AWXO-XX

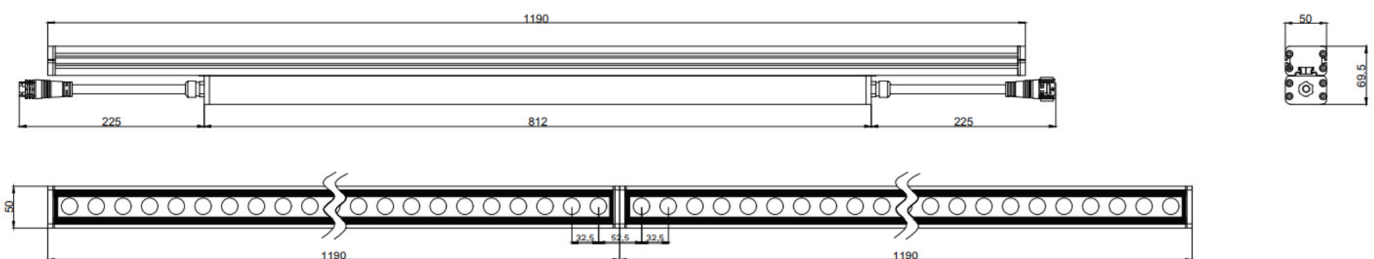

# Mounting Accessories

Units: mm

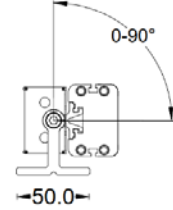
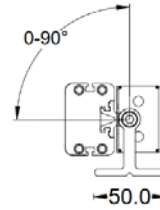
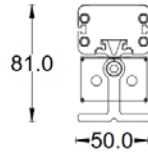
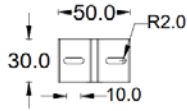

ITEM: W-LP-Mount-81

**DESCRIPTION:** Adjustable mounting option for applications that require angle adjustments. It can rotate up to 180 degree.

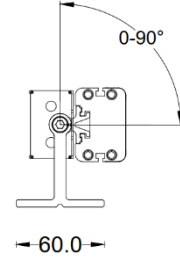
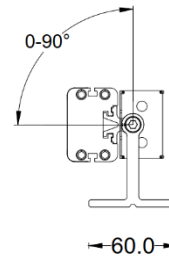
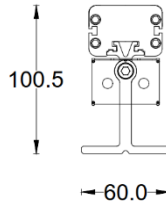
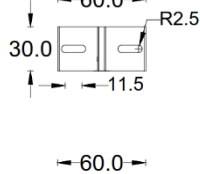

ITEM: W-LP-Mount-100

**DESCRIPTION:** Adjustable mounting option for applications that require angle adjustments. It can rotate up to 180 degree.

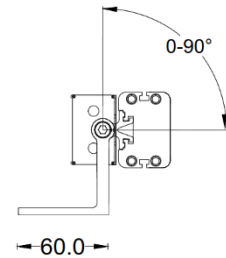
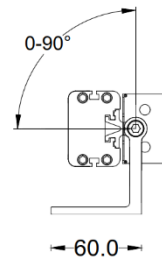
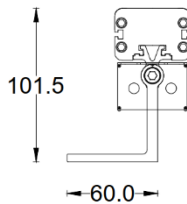
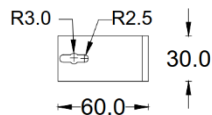

ITEM: W-LP-Mount-Lbracket

**DESCRIPTION:** L-shape adjustable mounting option for applications that require angle adjustments. It can rotate up to 180 degree.



# Mounting Accessories

Units: mm



**ITEM:** W-LP-Antiglare  
Asymmetric anti-glare louver that coordinates to length of the wall washer.

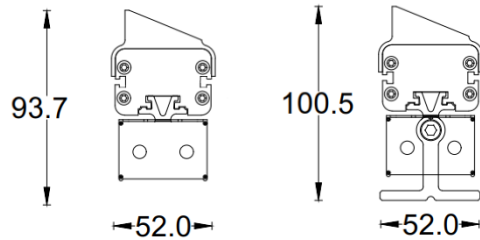

**ITEM:** W-LP-Mount-Stake

**DESCRIPTION:** Adjustable mounting option for landscape lighting application

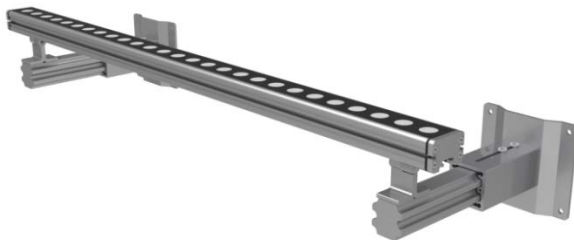
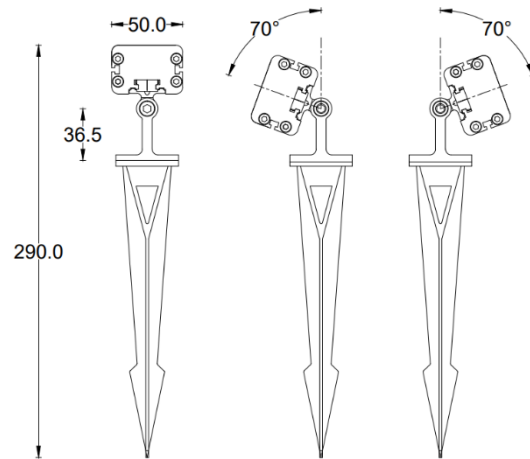

**ITEM:** W-LP-Mount-ExtendedS  
**ITEM:** W-LP-Mount-Extended

Wall mount option for application that requires wall mounting with length 150mm – 230mm  
Wall mount option for application that requires wall mounting with length 355mm – 560mm

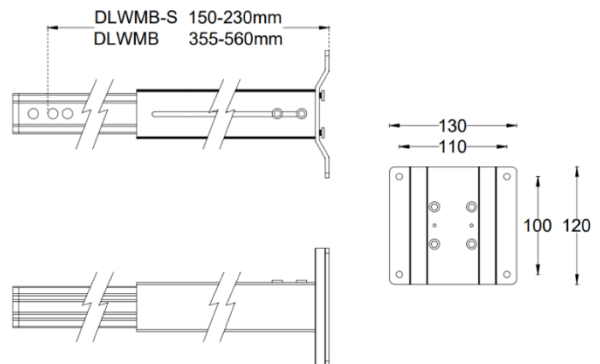

*\*need to order this item together with the fixture as it requires special mounting brackets to lock the wall mounting arm.*



## Cable Accessories

Product Code	Description
W-CNT-3F-AC	Wall Washer connector, IP66, 3-pin Female, AC Power input
W-CNT-3JP-XX	Wall Washer connector, IP66, 3-pin Jumper, XX inch length
W-TMN-3M	Wall Washer connector, IP66, 3-pin Male, AC End Cap

